

# Shower Systems

by Noble Company

[www.noblecompany.com](http://www.noblecompany.com)

Visit our website for complete in-depth instructions, diagrams, and how-to videos on all of your favorite Noble products. [www.noblecompany.com](http://www.noblecompany.com)



## THIN-BED SHOWER SYSTEM

1. NobleBond EXT membrane adhesive
2. NobleSeal® TS waterproofing sheet membrane
3. Thin-Bed Drain
4. Inside Corner
5. Noble Niche
6. Noble Bench
7. Noble Solid Curb

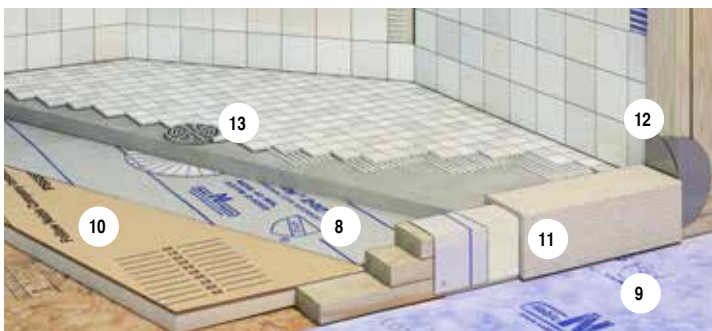

## FULL MORTAR BED SHOWER SYSTEM

8. Chloraloy® premium shower pan
9. NobleSeal TS waterproofing sheet membrane
10. PRO-SLOPE™ preformed slope
11. Noble Curb Overlay
12. Outside/Dam Corner
13. Clamping Ring Drain

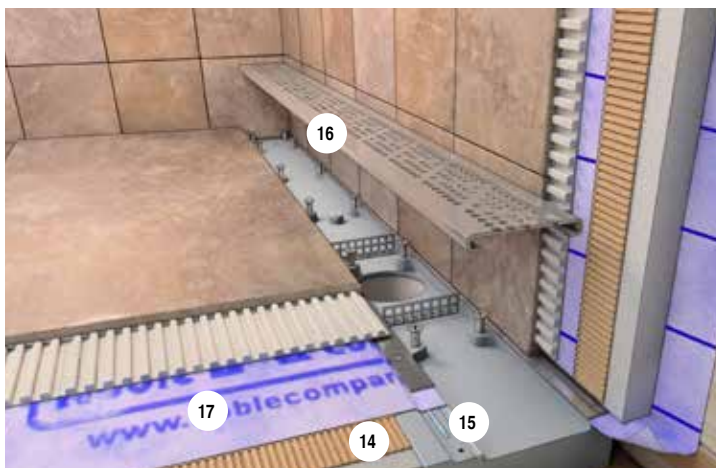

## FREESTYLE LINEAR DRAIN SYSTEM

14. NobleBond EXT membrane adhesive
15. NobleSealant 150 seam sealant
16. FreeStyle Linear Drain™
17. NobleSeal TS waterproofing sheet membrane

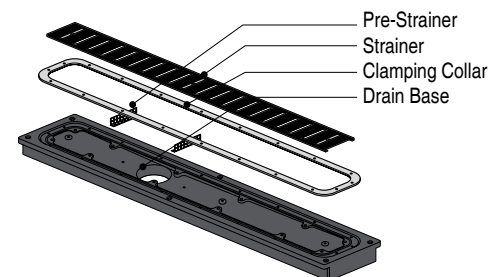

# Complete Shower Waterproofing Products

Start your next shower project by selecting the Noble system that meets your needs!

VIEW MORE PRODUCTS  
AND DETAILS ONLINE

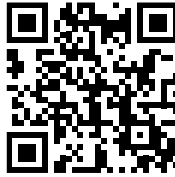

Visit our website for complete in-depth instructions, diagrams, and how-to videos on all of your favorite Noble products.

[www.noblecompany.com](http://www.noblecompany.com)



#### **Noble Niches** Shower Recesses

Preformed, waterproof niches in a wide variety of sizes and styles for tile showers. Made from extruded polystyrene (XPS) and coated with acrylic polymer finish that is ready for tile.



#### **Noble Benches** Shower Benches

Preformed, ready-for-tile, waterproof benches for shower applications. Made from expanded polystyrene (EPS) and coated with acrylic polymer finish for thin-set installation of ceramic or stone tile.



#### **NobleSeal® TS** Waterproofing Membrane

Waterproofing and crack isolation for ceramic, stone, terrazzo tile, and other hard surface flooring in thin-bed applications.



#### **NobleBond EXT** Sheet Membrane Bonding

Wet-set adhesive for bonding NobleSeal and Noble Deck Sheet membranes in interior and exterior applications.



#### **Chloraloy®** Shower Pan Liner

The original CPE shower pan liner for full mortar bed waterproofing applications.



#### **NobleSealant 150** Sheet Membrane Seaming

Waterproof sealant used to seam sheets together, seal penetrations, drains, edges, and corners.



#### **FreeStyle** Linear Drains™

Offers contemporary styling with exceptional design flexibility, reliability, and installation simplicity.

U.S. Patent No. 8,474,068

Patents Pending: Canada

and EP Publication No. 2354339



#### **Pro-Slope™** Code Required Preslope

Patented, preformed composite made from expanded polystyrene (EPS) with a reinforced cutting template that creates a code-required slope under the waterproofing membrane in a full mortar bed application.



#### **Noble Curbs** Preformed Curbs

Creates a ready-for-tile surface over the dam. Made from expanded polystyrene (EPS) and coated with acrylic polymer finish for thin-set installation of ceramic or stone tile.



#### **ProBase®** Preformed Shower Base

A waterproof, sloped shower base that is ready for tile and can be quickly installed.



#### **ValueSeal™** Waterproofing Membrane

Value priced, ultra thin sheet membrane for waterproofing showers.



#### **Outside & Inside Corners** Preformed Corners

Protect against leaks in problem areas (i.e. dams, outside corners, inside corners). Create a quicker watertight installation.



P.O. Box 350 · Grand Haven, MI 49417-0350 · 800-878-5788 · Fax: 231-799-8850 · [www.noblecompany.com](http://www.noblecompany.com)

© Registered Trademark of Noble Company, Grand Haven, MI. ™ Trademark of Noble Company, Grand Haven, MI. © 2014 Noble Company

File #D9112014-03 | 11/14 | Supersedes D9052014-19