

# **Sheet Membrane & Shower Products Catalog**

*Simple Solutions... Proven Performance*

  
www.noblecompany.com

**NOBLESEAL® TS 186**  
**ANSI A118.10**



  
www.noblecompany.com

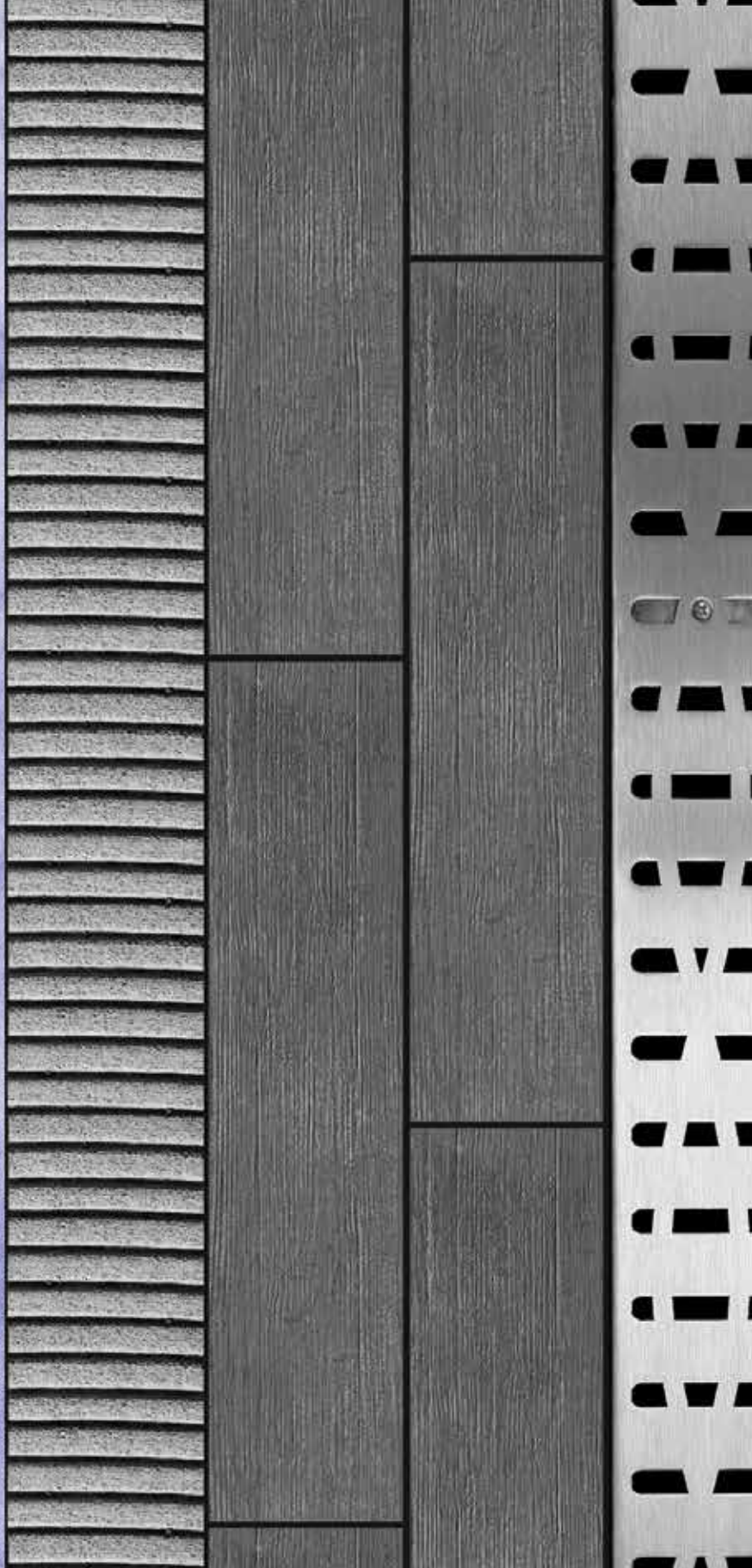

# NobleSeal® Sheet Membranes

For over 45 years, Noble Company has pioneered the use of sheet membranes in the tile and stone industry. At the heart of all Noble systems is a core layer of Chlorinated Polyethylene (CPE), an inherently flexible elastomeric sheet that will not rot, crack or deteriorate due to microorganisms. Sheet membranes are available for crack isolation, waterproofing, joint bridging, and sound isolation. NobleSeal sheets save time and money. Noble membranes are easy to install and provide quality solutions to prevent costly failures. All of Noble's membranes are made in the U.S.A.



## Performance Tested

Ensuring that our products are designed to meet the challenges of industry standards is part of Noble's quality assurance program. NobleSeal products have undergone stringent testing to industry standards including ANSI and ASTM, as well as meeting the code requirements of the UPC and IPC. In addition, Noble Company is integral in the continuous improvement and development of installation guidelines and requirements through participation in organizations such as TCNA, NTCA, TCAA, RPA, ISO, ANSI, MMSA and MIA.



ICC-ES PMG™



## Features & Benefits of NobleSeal:

### Versatility

- Use over common substrates, even:
  - Primed gypsum underlays
  - Radiant heating systems
  - Most impervious substrates
  - Many wood subfloors
- Use for new construction or renovation in residential or commercial applications

### Durability

- Made from CPE, won't rot or crack
- Guaranteed for the life of the original tile installation
- Excellent resistance to chemicals
- Unaffected by a wide range of temperatures & conditions

### Installation

- Uniform thickness ensures quality installations by reducing workmanship variables
- Simple installation process:
  - Spread bond coat, embed sheet, install tile

### Crack Protection

- Isolates tile from the substrate to prevent telegraphing substrate defects
- Highest level of protection and Performance:
  - Rated "High Performance" in System Crack Resistance portion of ANSI A118.12
  - Rated "Extra Heavy" by Robinson Floor Test

### Waterproofing

- Impervious: protects against water and vapor transmission
- Suitable for shower and steam room waterproofing

## Noble Sheet Membrane Use Guide



Use Guide	Crack Isolation	Water Proofing	Joint Bridging	Sound Reduction	Exterior Decks
Chloraloy®		X			X
NobleSeal® TS	X	X	X		
NobleSeal® CIS	X	X	X		
NobleSeal® SIS	X	X	X	X	
NobleDeck™	X	X	X		X
Wall Seal™ <small>(PVC membrane for walls only)</small>		X			

## Quick & Easy Installation



1. Apply bonding agent.



2. Embed sheet.



3. Install Tile.

Unlike fluid-applied products, our sheet membranes do not require curing, so work can progress as soon as sheets are installed. Sheets also minimize variables in workmanship. Large sections can be created by seaming sheets together.





Noble Company, Spring Lake, Michigan

## About Noble Company

Founded in 1946, the Noble Company has established a reputation of providing quality, innovative products for the plumbing and tile industries. Identifying problems and developing solutions that add value and exceed customer expectations has been the ongoing mission of our company. Noble Company products are available globally through our distribution network.

## Instructional Videos

Noble Company offers free online and DVD instructional videos. The videos demonstrate installation techniques of full mortar bed and thin-set methods for showers, as well as an overview of the FreeStyle Linear Drain systems. These helpful videos can be found online at [noblecompany.com](http://noblecompany.com). DVDs may be ordered through [sales@noblecompany.com](mailto:sales@noblecompany.com) or from a Noble Company Sales Representative.

## Contractor Training Programs

Noble offers contractor training programs focusing on installation methods used with NobleSeal products in commercial and residential applications. The programs are specifically designed to help tile contractors:

- Avoid costly callbacks
- Improve installation efficiency; optimize time, energy, & money
- Maximize shower sales

These hands-on trainings are being held in various locations throughout the United States and Canada. For more information and to see when a training will be held in your area, please contact us at 1-800-878-5788.

## Continuing Education Seminars

Noble Company is an Authorized Provider of Continuing Education for AIA and ASID. We conduct seminars for design and construction professionals. These seminars provide information about cost-effective solutions to problems created by today's fast-paced, cost-driven construction techniques.



The programs offer learning unit credits for AIA Continuing Education and Health, Safety & Welfare (LU/HSW). To register for a seminar or obtain more information, contact your local Noble Company Sales Representative or Noble Company at 800-878-5788 or e-mail: [sales@noblecompany.com](mailto:sales@noblecompany.com).

## Table of Contents

### Sheet Membranes

Chloraloy .....	2
NobleSeal TS .....	2
NobleSeal SIS.....	2
NobleSeal CIS .....	3
Noble Deck .....	3
Wall Seal.....	3

### Bonding Agents & Sealants

NobleBond EXT.....	4
NobleBond 21 .....	4
NobleSealant 150 .....	4
NobleWeld 100.....	5

### Shower Drains

Clamping Ring Drains.....	5
Thin-Bed Shower Drains.....	5
FreeStyle Linear Drains™.....	6

### Shower Accessories

Noble Niches.....	7
Noble Benches.....	7
Noble Shelf Bench .....	7
Noble Curbs.....	8
ProBase®.....	8
PRO-SLOPE™.....	8
Positive Weep Protectors™.....	8
NobleFlex® .....	9
Dam/Outside & Inside Corners.....	9

## Merchandising & Point-Of-Purchase Materials

As a key supplier to hundreds of distributors and retailers throughout the world, Noble Company provides business partners with integral merchandising and point-of-purchase materials. Shower accessory displays (such as the FreeStyle Linear Drain Displays) and our NobleSeal Sheet Membrane samples and literature are available as sales aids to retailers and distributors.



## Noble is a member of the following Organizations & Associations:





TCNA  
Env. Class  
COM  
2-6  
RES  
2-6



TCNA  
Env. Class  
COM  
1-5  
RES  
1-5



TCNA  
Env. Class  
COM  
1-3  
RES  
1-3

## Chloraloy®



The original CPE shower pan liner for full mortar bed waterproofing applications.

#### Features & Benefits

- Easy to install, naturally flexible, will hold a crease
- Saves time - no curing
- Maximum waterproof protection with lowest water/vapor transmission rate
- Guaranteed for life of the original tile installation
- 40+ years of proven performance

#### Testing & Standards

- Meets ASTM D4068
- ASTM E96 - Moisture/Vapor Transmission Rate:
  - Procedure A: 0.07 perms
- Meets IPC and UPC requirements: IAPMO (File #3046)

#### Applications

- All wet areas (i.e. steam rooms, showers)
- Residential - new construction & remodeling
- Food courts
- Hotels
- Condominiums
- Health clubs
- Military and university housing
- Healthcare facilities

#### Dimensions

Nominal Thickness: .040" (1.0mm)

← Approximate thickness of membrane

Roll Sizes:

- 4' x 50' = 200 sq. ft., 1.2m x 15.2m = 18.6m<sup>2</sup>
- 5' x 40' = 200 sq. ft., 1.5m x 12.2m = 18.6m<sup>2</sup>
- 6' x 33.3' = 200 sq. ft., 1.8m x 10.1m = 18.6m<sup>2</sup>

## NobleSeal® TS



Waterproofing and crack isolation for ceramic, stone, and terrazzo tile and other hard surface flooring in thin-bed applications.

#### Features & Benefits

- Fastest waterproofing system available
- Thin CPE sheet membrane
- Bond with NobleBond EXT for fast cure time
  - Can be bonded with latex modified thin-set
- Low water/vapor transmission rate
- Provides crack isolation

#### Testing & Standards

##### Waterproofing:

- Meets ANSI A118.10
- ASTM E96 - Moisture/Vapor Transmission Rate
  - Procedure E: .15 perms (high humidity)
- Thin-bed shower waterproofing
  - IAPMO Listing: UPC File No. 4339
  - ICC- ES PMG Listing: PMG -1059

##### Crack Isolation:

- ASTM C627: Performance Rating: "Extra Heavy"
- ANSI A118.12: System Crack Resistance (Jig Test) Rated "High Performance"

#### Applications

- All wet areas (i.e. steam rooms, showers)
  - Horizontal and vertical surfaces
- Food courts
- Hotels
- Condominiums
- Health clubs
- Military and university housing
- Malls and plazas
- Healthcare facilities

#### Dimensions

Nominal Thickness: .030" (0.8mm)

← Approximate thickness of membrane

Roll Sizes: 5' x 100' = 500 sq. ft.

1.5m x 30.5m = 46.5m<sup>2</sup>

## NobleSeal® SIS



Reduces floor-to-floor impact sound from hard surface flooring. (U.S. Patent No. 6,077,613)

#### Features & Benefits

- Thin CPE sheet membrane
  - Simplifies transitions between different types of flooring
  - Eliminates the need to alter door & cabinet heights
- Provides waterproofing and crack isolation

#### Testing & Standards

##### Sound Reduction:

- ASTM E492; ASTM E90: IIC = 62; STC = 59  
Tested floor/ceiling assembly: 8" Hollow-core concrete substrate & sound rated ceiling.
- ASTM E2179: Δ = 12
- Meets ANSI 118.13

##### Waterproofing:

- Meets ANSI A118.10
- Thin-bed shower waterproofing
  - IAPMO Listing: UPC File No. 4339
  - ICC- ES PMG Listing: PMG -1059

##### Crack Isolation:

- ASTM C627: Performance Rating: "Extra Heavy"
- ANSI A118.12: System Crack Resistance (Jig Test) Rated "High Performance"

#### Applications

- High-rise office buildings
- Condominiums
- Libraries
- Hotels
- Apartment buildings
- Military and university housing
- Educational facilities
- Healthcare facilities

#### Dimensions

Nominal Thickness: .050" (1.3mm)

← Approximate thickness of membrane

Roll Sizes: 6' x 33.3' = 200 sq. ft.

1.8m x 10.2m = 18.6m<sup>2</sup>



TCNA  
Env. Class

- COM 1-5
- RES 1-5

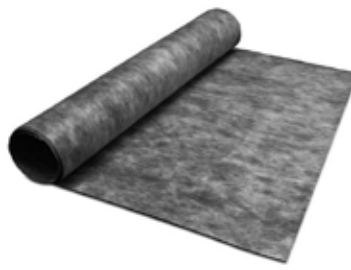

TCNA  
Env. Class

- COM 2-6
- RES 2-6



TCNA  
Env. Class

- COM 2-5
- RES 2-5

## NobleSeal® CIS

### Crack Isolation

Protects thin-bed tile from cracking by relieving the stress caused by horizontal movement in the substrate.

#### Features & Benefits

- Allows tile to bridge cracks and control joints
- Thin CPE sheet membrane
- Helps preserve tile patterns
- Fast and easy to install
- Also provides waterproofing

#### Testing & Standards

##### Crack Isolation:

- ASTM C627: Performance Rating: "Extra Heavy"
- ANSI A118.12: System Crack Resistance (Jig Test) Rated "High Performance"

##### Waterproofing:

- Meets ANSI A118.10
- Thin-bed shower waterproofing
  - IAPMO Listing: UPC File No. 4339
  - ICC- ES PMG Listing: PMG -1059

#### Applications

- Shopping centers
- Hotels
- High-rise offices
- Airports
- Department stores
- Single & multi-unit housing
- Radiant heating systems

#### Dimensions

Nominal Thickness: .030" (0.8mm)

← Approximate thickness of membrane

Roll Sizes:

- 2' x 50' = 100 sq. ft., 0.6m x 15.2m = 9.3m<sup>2</sup>
- 3' x 50' = 150 sq. ft., 0.9m x 15.2m = 13.9m<sup>2</sup>
- 4' x 50' = 200 sq. ft., 1.2m x 15.2m = 18.6m<sup>2</sup>
- 6' x 50' = 300 sq. ft., 1.8m x 15.2m = 27.9m<sup>2</sup>

## Noble Deck™

### Exterior Waterproofing

Exterior thin-bed waterproofing and crack protection where ceramic or stone tile is used.

#### Features & Benefits

- Bondable CPE sheet membrane for primary waterproofing over occupied spaces
- Provides waterproofing, crack isolation, and joint bridging
- Bond with NobleBond EXT for fast cure time
  - Can be bonded with latex portland cement mortar

#### Testing & Standards

##### Waterproofing:

- Meets ANSI A118.10
- Thin-bed shower waterproofing
  - IAPMO Listing: UPC File No. 4339
  - ICC- ES PMG Listing: PMG -1059

##### Crack Isolation:

- ASTM C627: Performance Rating: "Extra Heavy"
- ANSI A118.12: System Crack Resistance (Jig Test) Rated "High Performance"

#### Applications

- Decks
- Plazas
- Balconies
- Walkways
- Pool Decks

#### Dimensions

Nominal Thickness: .040" (1.0mm)

← Approximate thickness of membrane

Roll Sizes:

- 6' x 50' = 300 sq. ft.
- 1.8m x 15.2m = 27.9m<sup>2</sup>

## Wall Sea™

### Waterproofing

Use for vertical walls in interior applications including showers.

#### Features & Benefits

- Superior waterproofing for walls versus liquid membranes
  - Low water/vapor transmission rate
  - Minimizes workmanship variables
  - Thin PVC sheet membrane
- Easy to install, saves time & money
  - No wet film gauge or fabric reinforcement needed
  - No curing, install tile immediately

#### Testing & Standards

- ASTM E96 - Moisture/Vapor Transmission Rate
  - Procedure A: .22 perms
  - Procedure E: .42 perms
- Meets ANSI A118.10

#### Applications

- All wet areas (i.e. steam rooms, showers)
  - vertical surfaces only
- Hotels
- Condominiums
- Health clubs
- Military and university housing
- Healthcare facilities

#### Dimensions

Nominal Thickness: 0.025" (0.6 mm)

← Approximate thickness of membrane

Roll Sizes:

- 6' x 66.7' = 400 sq. ft.
- 1.83 m x 20.3 m = 37.2 m<sup>2</sup>



## NobleBond EXT

### Sheet Membrane Bonding

Wet-set adhesive for bonding NobleSeal and Noble Deck sheet membranes in interior and exterior applications.

#### Features & Benefits

- High strength, water resistant bond
- Fast cure time
- Non-flammable
- Low odor and zero VOCs
- No solvents, ammonia or hazardous chemicals
- Contains MicroSept™ antimicrobial protection, which inhibits growth of mildew & bacteria

#### Applications

- Interior & Exterior Applications
  - Including wet areas (not steam rooms)
  - Horizontal & vertical surfaces
- Use over:
  - Cured concrete
  - Cementitious backer boards
  - Suitable plywoods
  - Terrazzo substrates
  - Some impervious substrates
- Use with Radiant Heating Systems

#### Spread Rate \*

Approximately 100 sq. ft./gallon

#### Application Method

Spread with a trowel.

#### Size(s)

1 or 4 gallon pails.

™ MicroSept is a Trademark of XL Brands, Calhoun, GA.

## NobleBond 21

### Sheet Membrane Bonding

Pressure sensitive, ready-to-use, latex-based adhesive. Use to bond NobleSeal sheet membranes for crack isolation/joint bridging and sound control on floors. Not suitable for vertical, exterior or wet area applications.

#### Features & Benefits

- No curing
- Low odor and zero VOCs
- Non-flammable
- Latex based, water clean-up

#### Applications

- Interior Applications
  - Horizontal surfaces only
- Use over:
  - Cured concrete
  - Primed gypsum underlayments
  - Suitable plywoods
  - Terrazzo substrates
  - Some impervious substrates
- Use with Radiant Heating Systems

#### Spread Rate \*

150-175 sq.ft./gal.

#### Application Method

Spread with trowel.

#### Size(s)

1 or 4 gallon pails.

\*Spread rates may be affected by substrate condition and porosity.

## NobleSealant 150

### Sheet Membrane Seaming

Polymeric sealant used to seam sheets together, seal penetrations, drains, edges, or corners.

#### Features & Benefits

- Times for curing can vary from 30 minutes to 24 hours depending on a variety of conditions (e.g. temperature, humidity, etc.)
- Unaffected by exposure to water after it has cured
- Adheres to wood, metal, concrete, glass, plastic & rubber
- Broad temperature use range
- Excellent resistance to ozone, sunlight & weathering

#### Applications

- Seam membrane sheets together
- Seal penetrations of the membrane
- As a concealed terminal edge & flashing sealant
- Adhere preformed corners to the waterproofing membrane, studs, etc.
- Spot bond sheet to vertical or horizontal surfaces

#### Spread Rate

3/16" bead - approximately 40 lin. ft.

#### Application Method

Apply with a heavy-duty commercial caulking gun.

#### Size(s)

10.3 oz. tubes.





## NobleWeld

### Sheet Membrane Seaming

Solvent welding system for seaming sheets of Chloraloy and NobleSeal TS.

#### Features & Benefits

- Chemically fuses bare CPE sheets of NobleSeal TS or Chloraloy
- Provides a high-strength seam

#### Applications

- Seam bare CPE membrane sheets

#### Spread Rate

1 pint seams 50 lin. ft.

#### Application Method

Applicator included in product.

#### Size(s)

1 pint or 1 quart containers.



**Strainer Finish:**  
Polished Brass  
PVC: #3882



**Strainer Finish:**  
Brushed Golden Nickel  
PVC (shown): #392  
ABS: #3921



**Strainer Finish:**  
Chrome Plated  
PVC (shown): #391  
ABS: #3911



**Strainer Finish:**  
Chrome Plated  
PVC (shown): #3912  
ABS: #3913



**Strainer Finish:**  
Matte Silver Stainless  
PVC: #3924



**Strainer Finish:**  
Polished Stainless  
PVC: #3926



**Strainer Finish:**  
Matte Silver Stainless  
PVC: #3923



**Strainer Finish:**  
Polished Stainless  
PVC: #3925

### Sizes & Dimensions

See the Clamping Ring Drain Product Description or CAD drawing for dimensions.



## Clamping Ring Drains

### High Quality Shower Drains

Three-part shower drains that provide a mechanical attachment of the waterproofing membrane to ensure waterproof integrity.

#### Features & Benefits

- Meet plumbing code requirements
- Mechanical attachment provides waterproofing integrity
- Weep slots and holes on both sides of collar maximize drainage
- Brass inserts in collar and tailpiece prevent damage from tightening

#### Shapes & Finishes



**Strainer Finish:**  
Oil Rubbed Bronze  
PVC (shown): #3891



**Strainer Finish:**  
Oil Rubbed Bronze  
PVC (shown): #3881



## Thin-Bed Shower Drains

### Top Mounted Clamping Collar

Thin-Bed drain with stainless steel clamping collar that can be tied directly into a sheet membrane waterproofing system.

#### Features & Benefits

- Clamping collar is flush with strainer
  - Designed for surface applied, bonded waterproofing membranes
  - Water flows directly into the drain, no weep holes
- Provides a watertight connection
- Strainer adjusts (from flush to 3/4") to accommodate various thicknesses of tile
- Low profile - Ideal for low profile, barrier-free showers (ADA)

#### Shapes & Finishes



**Strainer Finish:**  
Chrome  
#3852



**Strainer Finish:**  
Chrome  
#3855



**Strainer Finish:**  
Stainless Steel  
#3851



**Strainer Finish:**  
Stainless Steel  
#3854



**Strainer Finish:**  
Brushed Golden Nickel  
#385



**Strainer Finish:**  
Brushed Golden Nickel  
#3853

### Sizes & Dimensions

See the Thin-Bed Shower Drain Product Description or CAD drawing for dimensions.



U.S. Patent No. 8,474,068  
 Patent Pending: Canada and  
 EP Publication No. 2354339



## FreeStyle Linear Drains™

### Linear Drains

FreeStyle Linear Drain is the only linear drain system with a clamping collar which assures a watertight seal with sheet membrane waterproofing. High GPM capacity. Ideal for barrier-free showers.

#### Features & Benefits

- Simple installation: fasten to floor, attach waste pipe, secure membrane to drain with clamping collar
- One-piece ABS or PVC base (no seams)
  - flat bottom for surface or recess mounting to substrate
  - Internal pre-strainer system
- Custom sizes and finishes are available (contact Noble Company for further info.)



#### Testing & Standards

- IAPMO Listing: UPC File No. 7249
- ICC-ES PMG Listing: PMG -1065

#### Sizes & Dimensions

- 24" Drain**  
24"L x 4-1/2"W x 1-1/4"D
- 32" Drain**  
32"L x 4-1/2"W x 1-3/8"D
- 36" Drain**  
36"L x 4-1/2"W x 1-3/8"D
- 40" Drain**  
40"L x 4-1/2"W x 1-7/16"D
- 48" Drain**  
48"L x 4-1/2"W x 1-1/2"D
- 54" Drain**  
54"L x 4-1/2"W x 1-9/16"D
- 60" Drain**  
60"L x 4-1/2"W x 1-5/8"D

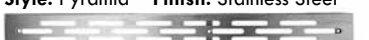
#### Strainer Styles & Finishes

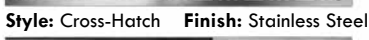
-  Style: Pyramid Finish: Stainless Steel
-  Style: Slotted Finish: Stainless Steel
-  Style: Wave Finish: Stainless Steel
-  Style: Cross-Hatch Finish: Stainless Steel
-  Style: Tile Top Finish: Insert your tile

## Full Mortar Bed Adapter Kits

### for FreeStyle Linear Drains

Allows for the use of a traditional shower pan liner (like Chloraloy®) to waterproof FreeStyle Linear Drains.

#### Features & Benefits

- Kit includes: hardware, brackets, and Mortar Guard
- Mortar Guard protects mud bed from erosion due to chemicals and debris
- Available for all sizes of FreeStyle Linear Drains
- Separate Kits available for use with Tile Top Strainers

#### CAD Reference

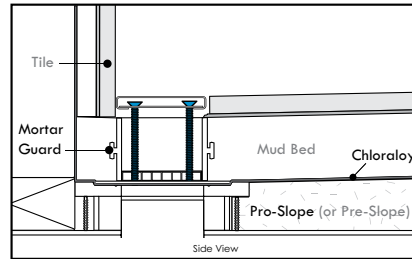

## Linear Drain Connectors

### Drain to Drain Connection

Connects any number or size FreeStyle strainers to give the impression of a continuous drain system. Three different Connectors allow any configuration of drains to be connected.

#### Features & Benefits

- Allows for mixing of drain lengths
- Ideal for large projects (interior or exterior) where multiple drains will be installed
- Brushed stainless steel finish

#### Drain Connection Chart

1 pc.	Part No. 8513 3.54" Coupler
1 pc.	Part No. 8514 4.6" Coupler
1 pc.	Part No. 8515 5.66" Coupler

Joining to ↓	Drain Size							
	24"	32"	36"	40"	48"	54"	60"	
Drain Size	24"	8513						
	32"	8513	8513					
	36"	8513	8513	8513				
	40"	8514	8514	8514	8515			
	48"	8513	8513	8513	8514	8513		
	54"	8513	8513	8513	8514	8513	8513	
	60"	8514	8514	8514	8515	8514	8514	8515







## Noble Niches

### Shower Recesses

Preformed, waterproof niches in a wide variety of sizes and styles for tile showers. Made from extruded polystyrene (XPS) and coated with acrylic polymer finish that is ready to tile.

#### Features & Benefits

- Installs in minutes
- Waterproof & ready-to-tile
- Mounts flush in 2" x 4" stud walls with 1/2" backerboard
- Durable and lightweight
- Custom sizes and shapes are available (contact Noble Company for further info.)

#### Sizes & Dimensions

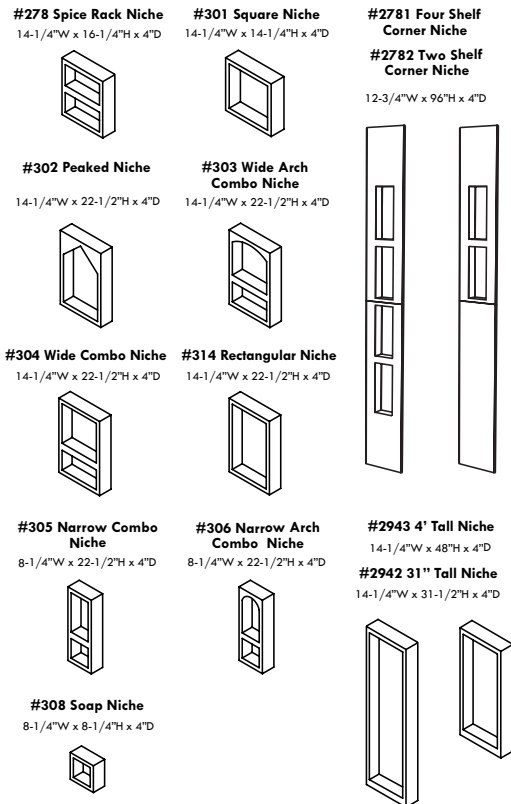

## Noble Benches

### Shower Benches

Preformed waterproof benches for shower applications. Made from expanded polystyrene (EPS) and coated with acrylic polymer finish that is ready-to-tile.

#### Features & Benefits

- Quick & easy installation
- Waterproof & ready-to-tile
- Durable
- Lightweight
- Custom sizes and shapes are available (contact Noble Company for further info.)

#### Shapes

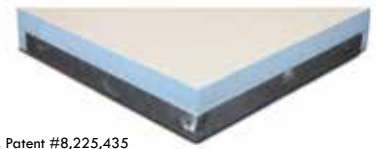
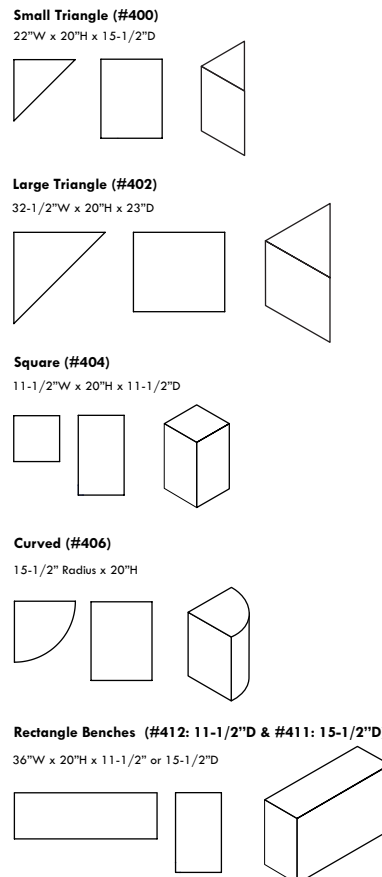

U.S. Patent #8,225,435

## Noble Shelf Bench

### Shower Bench

Provides a ready-to-tile shelf bench. Seat is made from extruded polystyrene (XPS), coated with acrylic polymer finish for thin-set installation of ceramic or stone tile and supported with a high quality aluminum frame.

#### Features & Benefits

- Quick & easy installation
- No mortar to mix & cure
- Waterproof & ready-to-tile
- For maximum productivity, tile can be installed off-site
- Durable, 400 lb. load capacity
- Lightweight

#### Sizes & Dimensions

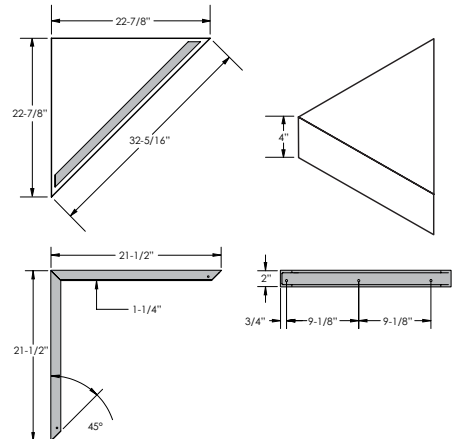

Shelf Bench (#414) and Shelf Bench 90° Support Frame



## Noble Solid Curbs & Curb Overlays

### Preformed Curbs

Creates a tileable surface over the dam. Made from expanded polystyrene (EPS) and coated with acrylic polymer finish for thin-set installation of ceramic or stone tile.

#### Features & Benefits

- Easy to install
- Eliminates penetrations of the shower pan liner inside or on top of the dam
- Lightweight
- Durable
- Cut to size with utility knife

#### Sizes & Dimensions

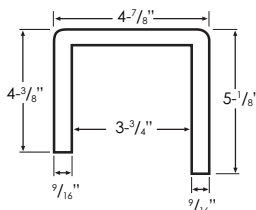

- 3' Long (#203)
- 4' Long (#201)
- 5' Long (#205)
- 8' Long (#202)\*

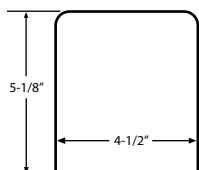

- 3' long (#3001)
- 4' long (#3002)
- 5' long (#3003)
- 8' long (#3004)\*

\*Available by Special Order only.

U.S. Patent #8,230,535



## ProBase®

### Preformed Shower Pan

One-piece, waterproof, sloped shower base that is ready-to-tile. Made from high strength polypropylene honeycomb with a Noble Sheet Membrane laminated to the top side. Cut to size with a standard utility knife. Install in minutes.

#### Features & Benefits

- Made from high strength polypropylene honeycomb with a Noble Sheet Membrane laminated to the top side
- Extra strong with a high point load capacity
- Compatible with standard clamping ring drains and allows for up to 2" of adjustment in drain position
- Packaged with all the necessary component products to ensure a watertight installation
- Available in custom sizes (min. quantity of 50)
- ICC-ES PMG Listing: PMG-1059

#### Sizes & Dimensions

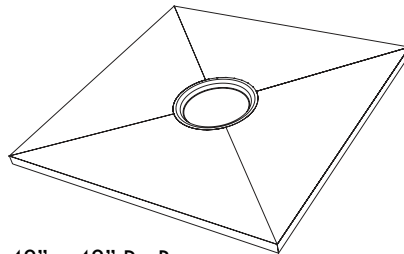

48" x 48" ProBase

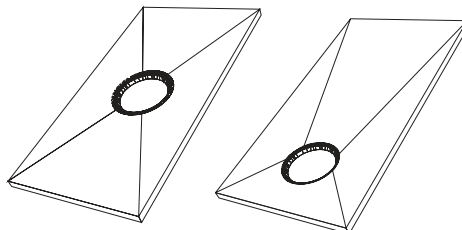

32" x 60" ProBase with center drain

32" x 60" ProBase with end drain

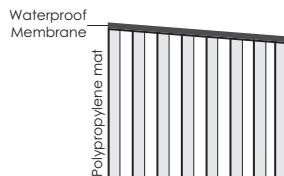

Side view of composite assembly.



U.S. Patent #5,140,789

## PRO-SLOPE™

### Code Required Preslope

Patented preformed composite made from expanded polystyrene (EPS) with a reinforced cutting template that creates a code required slope under the waterproofing membrane in a full mortar bed application.

#### Features & Benefits

- Slope allows moisture to drain
- Helps eliminate a main cause of mildew and fungus
- Saves time - light and easy to cut
- Durable: Rated at 500 lbs./sq. ft.
- Easy to cut and install

#### Sizes & Dimensions

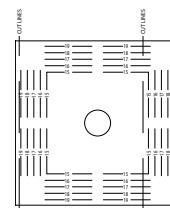

- 40" x 40" PRO-SLOPE Kit
- 60" x 60" PRO-SLOPE Kit
- 40" x 80" Tub Replacement Kit
- 20" X 40" Tapered Extension
- 20" X 40" Flat Extension
- 30" X 60" Tapered Extension
- 30" X 60" Flat Extension



## Positive Weep Protector™

### Drainage Solution

Keeps weepholes in clamping ring open to facilitate drainage.

#### Features & Benefits

- Highly effective and affordable
- Helps prevent mortar bed saturation
- Easy to install, permanent solution
- Included in each PRO-SLOPE Kit, also available as an individual accessory



U.S. Patent #7,632,401

## NobleFlex®

### Drain Flashing

Provides smooth transition of thin-set waterproofing sheet membrane to a clamping ring drain.

#### Features & Benefits

- Ideal for thin-set waterproofing membranes (ANSI A118.10) or full mortar bed membranes when the drain is set too low
- Thin-bed shower waterproofing
  - IAPMO Listing: UPC File No. 4339
  - ICC-ES PMG Listing: PMG-1059
- Alternative to "integrated bonding flange" drains
- Easy to install

#### Sizes & Dimensions

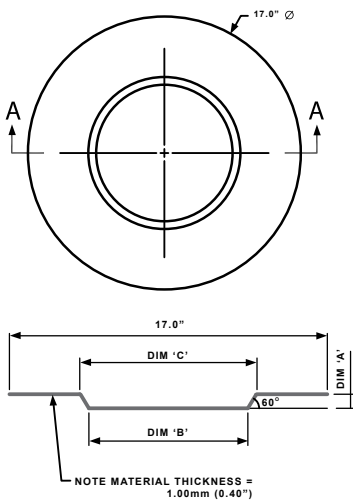

#### NobleFlex 1-1/2" Deep

- Dimension A: 1-1/2"
- Dimension B: 8-1/2"
- Dimension C: 10-1/5"

#### NobleFlex 3/4" Deep

- Dimension A: 3/4"
- Dimension B: 8-1/2"
- Dimension C: 9-2/5"



## Dam/Outside Corners

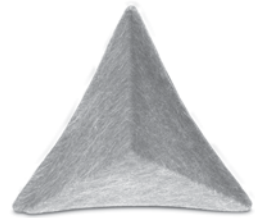

## Inside Corners

### Preformed Corners

Protects against leaks in problem areas (i.e. dams, outside corners, inside corners). Provides a quicker, watertight installation.

#### Features & Benefits

- Made from Chlorinated Polyethylene
- Will not rot, crack or deteriorate due to microorganisms

#### Sizes & Dimensions

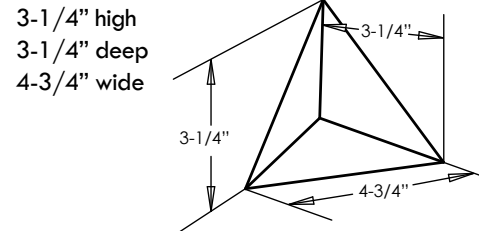
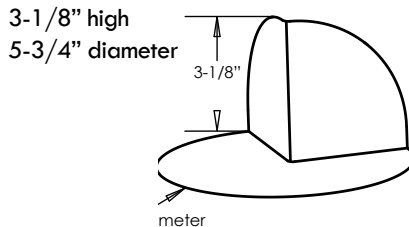

Start your next shower project by selecting the Noble System that meets your needs!

### Full Mortar Bed System

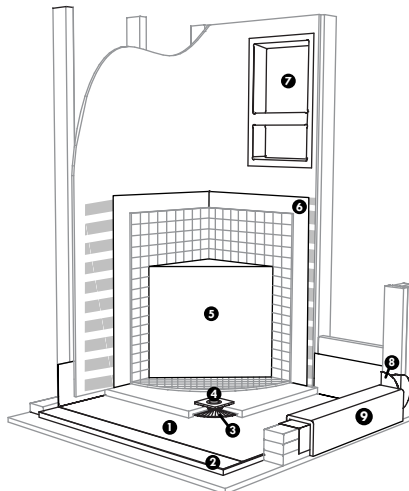

#### Recommended Products:

- q Chloraloy®
- w PRO-SLOPE™
- e Positive Weep Protector™
- r Clamping Ring Drain
- y WallSeal™, seam with PVC Seam Cement OR NobleSeal® TS, seam with NobleSealant 150
- i Outside/Dam Corners
- o Noble Curb Overlay

### Thin-Bed System

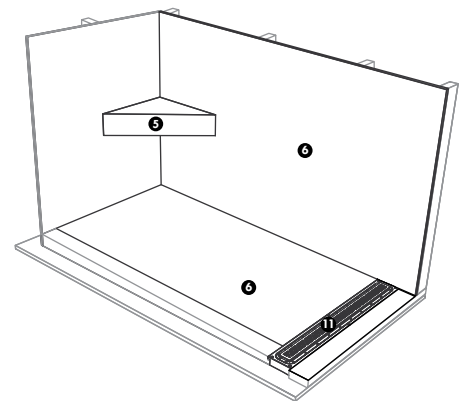

#### Recommended Products:

- s FreeStyle Linear Drain™
- y NobleSeal® TS, bond to substrate with thin-set & seam with NobleSealant 150





***When time and performance are the critical factors in projects, Noble can provide simple solutions with proven performance. Noble sheet membranes and shower products have been installed in some of the most prestigious properties around the world. Here are just a few of our high-profile installation projects...***



City Center Project, Las Vegas, Nevada  
Products Installed: NobleSeal TS, NobleBond EXT, NobleSealant 150, Shower Accessories, Noble Deck, and NobleSeal SIS



Atlantis Resort & Hotel, Bahamas  
Products Installed: NobleSeal SIS



Burj Khalifa, Dubai, United Arab Emirates (UAE)  
Products Installed: NobleSeal TS and Chloraloy