

Noble Shelf Bench

Installation Instructions

www.noblecompany.com

U.S. Patent No. 8,225,435
Canadian Patent No. 2649450

1. PRODUCT & MATERIALS

- 1.1 Noble Shelf Benches are made from high density XPS with a latex modified finish on the top and front. Noble Shelf Benches are waterproof and ready-to-tile. They are lightweight, durable, and are not a food source for fungus and mold. The 90° and inner support frames are constructed of aluminum.
- 1.2 Other Materials: Drill, 5/16" and 7/16" Driver, 5/32" Drill Bit, Tape Measure, Level, 100% Silicone Caulking, and Square.

2. PREPARATORY WORK

- 2.1 Ensure that the walls where the Shelf Bench is to be installed are reasonably square.

3. INSTALLING SHELF BENCH

- 3.1 If studs do not line up with every lag bolt hole on the 90° frame, 2" x 4" blocking is required. **Important:** LAG BOLTS MUST BE SCREWED INTO SOLID WOOD BLOCKING. Cement board or "dry wall" does NOT qualify as solid blocking. Caution: If every lag bolt is not secured to wall studs or anchored into wood blocking, the bench will not hold under weight.
- 3.2 Install suitable tile backer board. Shower should be waterproofed in accordance with Tile Council of North America (TCNA) guidelines and all applicable codes prior to the installation of the Shelf Bench.
- 3.3 Set 90° frame to desired height. Level the frame and mark the wall where six lag bolts will go.
- 3.4 Pre-drill the six holes with a 5/32" drill.
- 3.5 Place a small amount of silicone in and around each hole drilled in wall.
- 3.6 Mount frame to wall using the six 1/4" lag bolts provided.
NOTE: Do not over tighten. This may cause the bolt head to snap off. It is recommended to finish tightening these by hand.
- 3.7 Position foam insert with textured side facing up. Line up the slots cut in the foam with the channel in the frame and push firmly in place.
- 3.8 On the bottom of the 90° frame, locate the two pre-drilled holes. Insert the provided #10 x 3/4" long self tapping screws and secure into place. *NOTE: Do not over tighten. This may cause the screw head to snap off. It is recommended to finish tightening these by hand.*
- 3.9 Put silicone bead along all edges where bench meets the wall.
- 3.10 Install tile or stone according to TCNA guidelines.
- 3.11 According to TCNA guidelines, all grout edges should have soft joints where the tile changes plane.

NOTE: For any situation not specifically covered, contact Noble Company's Technical Department at 1-800-878-5788, before proceeding.

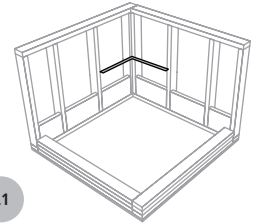

2.1

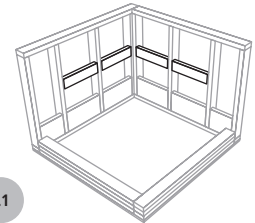

3.1

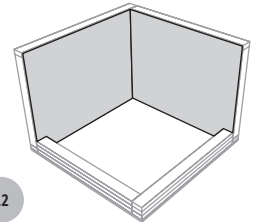

3.2

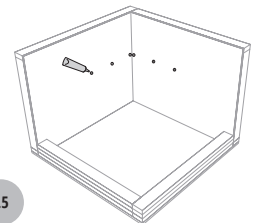

3.5

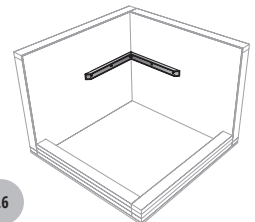

3.6

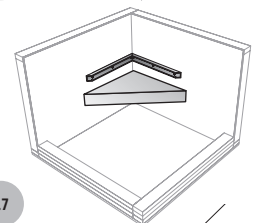

3.7

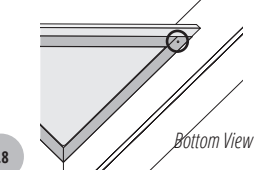

3.8

SHELF BENCH #414

32 5/16" wide
4" high
22 7/8" deep

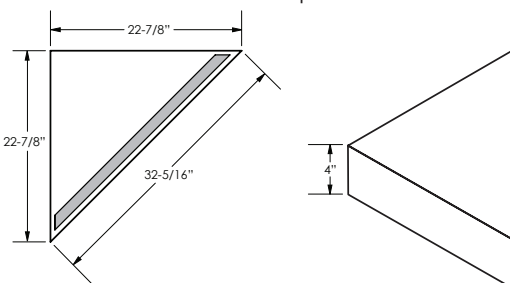

SHELF BENCH FRAME

2" high
21 1/2" deep

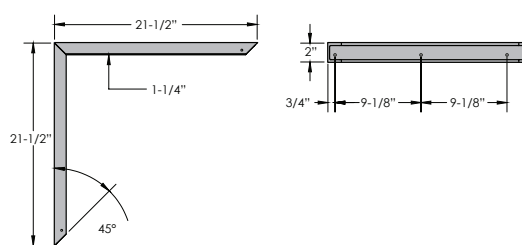

Simple Solutions... Proven Performance



7300 Enterprise Drive, Spring Lake, MI 49456 · 800-878-5788

Fax: 231-799-8850 · www.noblecompany.com

® Registered Trademark of Noble Company

™ Trademark of Noble Company, Spring Lake, MI. ©2019 Noble Company

File #SB072019-01 | 07/19 | Supersedes SB042016-15

VIEW MORE PRODUCT
DETAILS, VIDEOS AND
DIAGRAMS ONLINE

